

NAME OF OWNERS :- MR. PRADIP KR. MUSTAFI & MR. SANJIB CHOWDHURY (PARTS. OF LNB REALITY) C.A OF SRI BAPI PAL & SMT. SHRABANI CHATTERJEE

- ALL EXTERNAL WALLS ARE 200 M.M. THICK.
- ALL INTERNAL WALLS ARE 125 M.M. & 75 M.M. THICK.
- CEMENT CONCRETE TO FOUNDATION, SLAB, BEAM, (Grade of conc- M 20
LINTEL, CHAJJA, 1: 1½: 3 CEMENT, SAND, STONE CHIPS, Grade of Steel Fe 500)
- CEMENT SAND MORTAR IN OUTER WALL - 1 : 6.
- CEMENT SAND MORTAR IN 75TH & 125TH PARTITION
WALL - 1 : 4 WITH WEIR NETTING.
- CEMENT SAND MORTAR IN CEILING PLASTER - 1 : 4.
- P.C.C. IN GROUND FLOOR : 1 : 3 : 6.

DOORS & WINDOWS SCHEDULE					
DOOR MKD.	WIDTH	HEIGHT	WIN. MKD.	WIDTH	HEIGHT
D1	1000	2100	W1	1500	1200
D2	900	2100	W2	1200	1200
D3	750	2100	W3	900	1200
D4 (S/F)	1400	2100	W4	600	700
D5 (S/F)	1425	2100			
D	1200	2100			

ASSESSEE NO :- 41- 130 - 03 - 0919 - 0

DETAILS OF REGD. DEED :-
(COMMON PASSAGE DECLARATION)

A. BOOK NO :-1	B. VOLUME NO :- 1607 -2021
C. PAGES NO. :- 337591 TO 337610	D. BEING NO :- 160709169

- | | | | | | | | |
|----------------------------------------------------------------------------------------------------------------------------------------------------------------------------------------------------------------------------------------------------------------------------------------------------------------------------------------------------------------------------------------------------------------------------------------------------------------------------------------------------------------------------|----------------------------|--------------------|-------------|-------------------|---|--------------------|----------------------------------------------------------------------------------------------------------------------------|
| <p>1. GROUND COVERAGE :-</p> <ul style="list-style-type: none"> ◦ PERMISSIBLE :- 123.392 SQM. (59.787 %) ◦ CONSUMED :- 112.064 SQM. (54.293 %) <p>2. TOTAL FLOOR AREA :-</p> <ul style="list-style-type: none"> ◦ TOTAL COV. AREA EXCLUDING THE SPACES EXEMPTED IN THIS RULE = 383.114 SQM. <table border="0"> <tr> <td>AREA EXEMPTED IN THIS RULE</td> <td>=</td> <td>58.460 SQM.</td> </tr> <tr> <td><u>TOTAL AREA</u></td> <td>=</td> <td><u>441.574 SQM</u></td> </tr> </table> | AREA EXEMPTED IN THIS RULE | = | 58.460 SQM. | <u>TOTAL AREA</u> | = | <u>441.574 SQM</u> | <p>3. F. A. R. :-</p> <ul style="list-style-type: none"> ◦ PERMISSIBLE :- 1.75 ◦ CONSUMED :- 1.735 |
| AREA EXEMPTED IN THIS RULE | = | 58.460 SQM. | | | | | |
| <u>TOTAL AREA</u> | = | <u>441.574 SQM</u> | | | | | |

DECLARATION OF GEO - TECHNICAL ENGINEER

UNDERSIGNED HAS INSPECTED THE SITE AND CARRIED OUT SOIL INVESTIGATION THEREON. IT IS CERTIFIED THAT THE EXISTING SOIL OF THE SITE IS ABLE TO CARRY THE LOAD FROM THE PROPOSED CONSTRUCTION & THE FOUNDATION SYSTEM PROPOSED HEREIN IS SAFE & STABLE IN ALL RESPECT FROM GEO - TECHNICAL POINT OF VIEW.

SIGNATURE GEO - TECHNICAL ENGINEER	
DECLARATION OF L. B. S.	
I DO CERTIFY WITH THAT THE BUILDING PLANS HAS BEEN DRAWN AS PER PROVISION OF K. M. C. BUILDING RULES 2009 AND AS AMENDED FROM TIME TO TIME AND THAT THE SITE CONDITION INCLUDING THE WIDTH OF THE ABUTTING K.M.C. ROAD CONFORM WITH THE PLAN AND THAT IS A BUILDABLE SITE AND NOT A TANK OR A FILLED UP LAND. THE LAND IS BOUNDED BY BOUNDARY WALL.	

<p>DECLARATION OF STRUCTURAL ENGINEER.</p> <p>THE STRUCTURAL DESIGN AND DRAWING OF BOTH FOUNDATION AND SUPER-STRUCTURE OF THE BUILDING HAS BEEN MADE BY ME ON THE BASIS OF SOIL INVESTIGATION REPORT MADE BY SOIL-TECH, 5/11/H, PRINCE GOLAM HUSSAIN SHAH ROAD, KOLKATA - 700032. SIGNED BY BHASKAR ROY CONSIDERING THAT ALL POSSIBLE LOADS INCLUDING THE SEISMIC LOADS AS PER THE NATIONAL BUILDING CODE OF INDIA LATEST REVISION & CERTIFIED THAT IT IS SAFE & STABLE IN ALL RESPECT.</p>

DECLARATION OF OWNERS

CONSTRUCTION /W/E SHALL FOLLOW THE INSTRUCTION OF L.B.S. & E.S.E. DURING CONSTRUCTION OF THE BUILDING (AS PER B.S.PLAN) K.M.C. AUTHORITY WILL NOT BE RESPONSIBLE FOR STRUCTURAL STABILITY OF THE BUILDING & ADJOINING STRUCTURES.

IF ANY SUBMITTED DOCUMENTS ARE FOUND TO BE FAKE, THE K.M.C. AUTHORITY WILL REVOKE THE SANCTION PLAN THE CONSTRUCTION OF WATER RESERVOIR AND SEPTIC TANK WILL BE UNDERTAKEN UNDER THE GUIDANCE OF E.S.E. /L.B.S. BEFORE STARTING OF BUILDING FOUNDATION WORK.

B.P. NO. :2021140245.. DATE :.09/12/2021..
VALID UP TO :.08/12/2026.

DIGITAL SIGNATURE OF A.E.

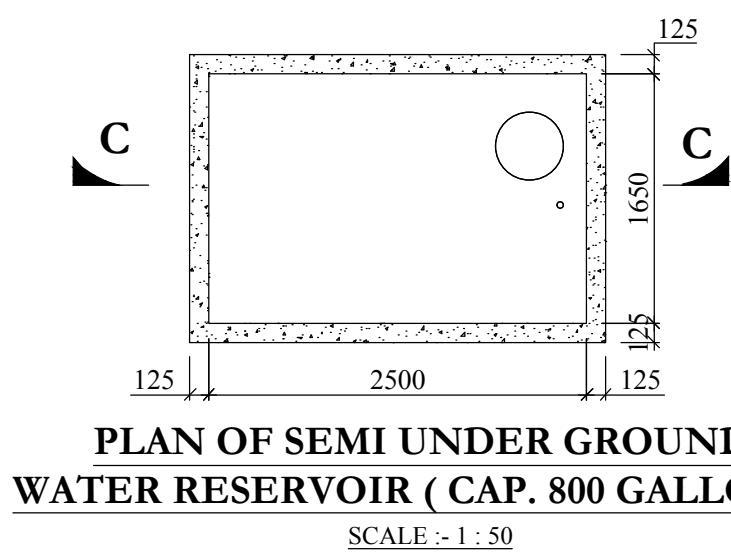

**PLAN OF SEMI UNDER GROUND
WATER RESERVOIR (CAP. 800 GALLONS)**
SCALE :- 1 : 50

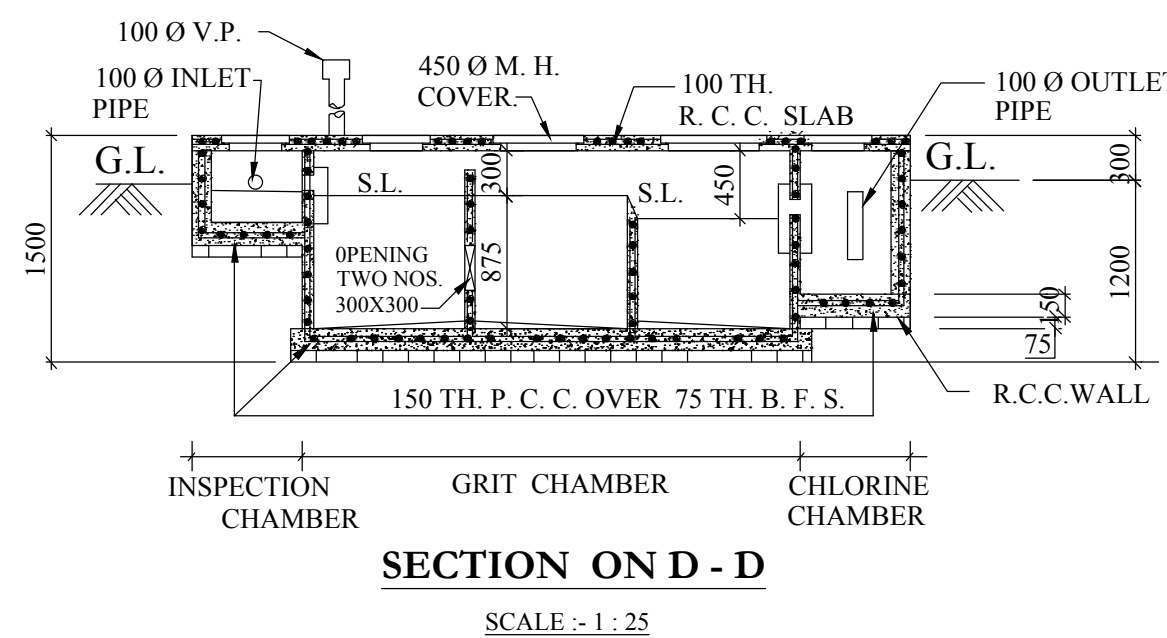

SECTION ON D - D
SCALE :- 1 : 25

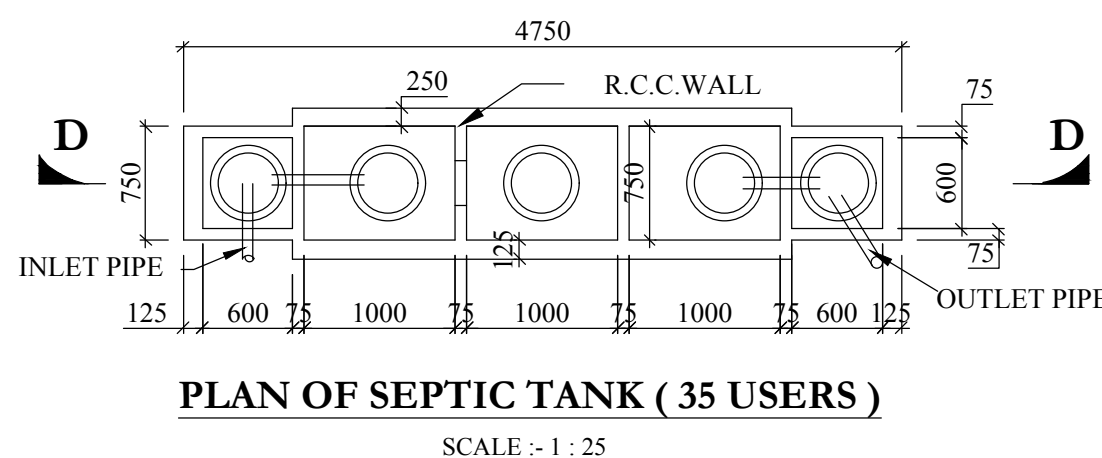

PLAN OF SEPTIC TANK (35 USERS)
SCALE :- 1 : 25

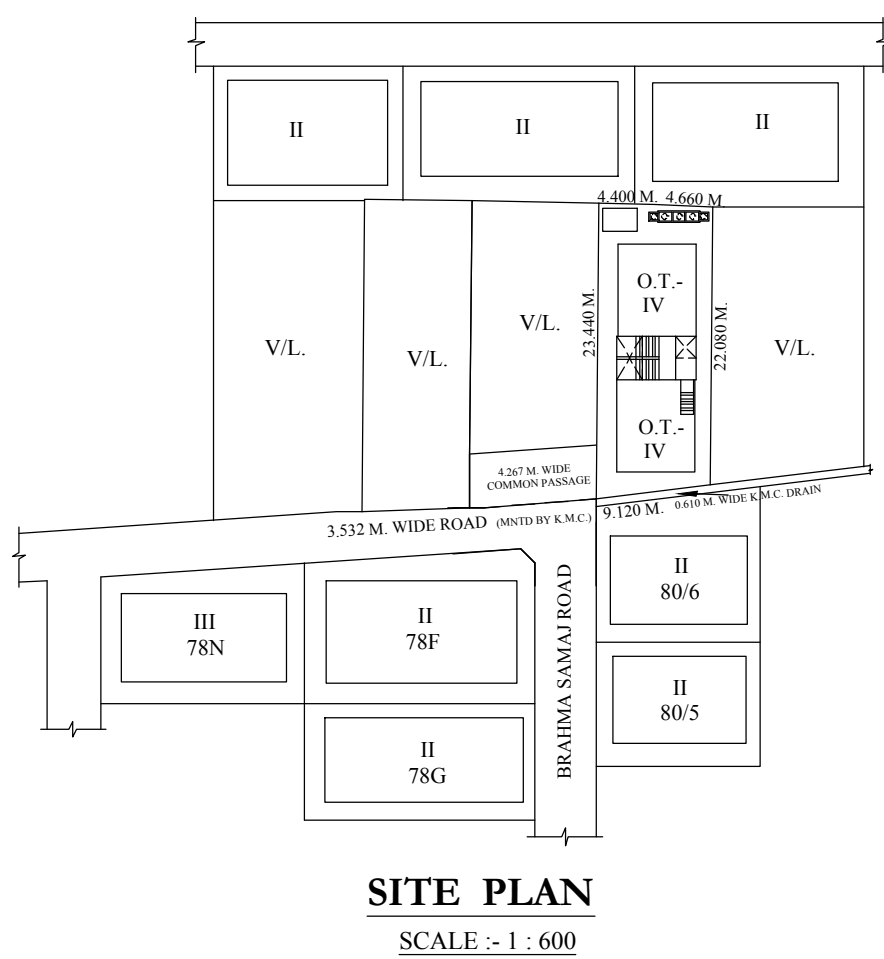

SITE PLAN
SCALE :- 1 : 600

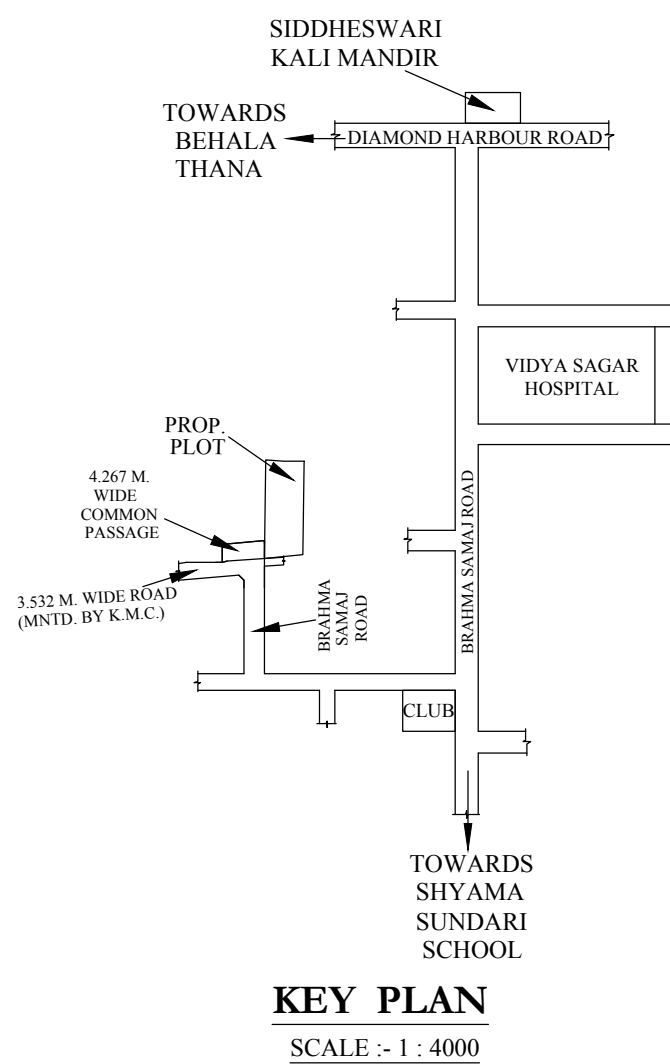

KEY PLAN
SCALE :- 1 : 4000

